

Steel Large Head Open End Hexagon Rivet Nut

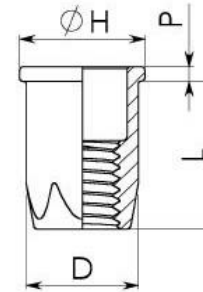

Steel Large Head Open End Hexagon Rivet Nut						
	Grip Range	L	H	P	D-A/F	Hole Size A/F +0.2 / -0.0
M4	0.5 - 2.0	10.00	9.00	1.00	5.90	6.10
M5	0.5 - 3.0	13.00	10.00	1.00	6.90	7.10
M6	0.5 - 3.0	14.20	13.00	1.50	8.90	9.10
M8	0.5 - 3.0	16.50	16.00	1.50	10.90	11.10
M8	3.0 - 5.5	19.50				
M10	0.5 - 3.5	19.50	19.00	2.00	12.90	13.10
M12	1.0 - 4.0	25.00	23.00	2.00	16.00	16.10

Material: Steel Zinc Plated (CR3)

INFORMATION AND DRAWINGS PROVIDED ARE FOR REFERENCE ONLY